

ProGM100



Overview

ProGM100 is a plug-n-play GSM/GPRS modem for direct integration with RS-232 interface. ProGM100 is a perfect solution to use with SMS gateways, access internet & data transfer

Features

- Tri band 850*/1800/1900 MHz GSM
- Data, SMS (Text & PDU), and GPRS (Class 10)
- AT Command Set Interface

Specifications

Module	Tri band GSM 900/ 1800/ 1900 MHz Quad band GSM 850/ 900/ 1800/ 1900 Mhz
Output Power	Class 4 (2W for GSM 900)
GPRS Packet Data	Class 1 (1W for GSM 1800) Class 10; Coding Scheme CS1 to CS4;
Feature	Embedded TCP/IP Stack
AT Commands Interface	GSM 07.05 and 07.07
Connectors	RS-232 Serial Port DC Power socket SMA Antenna connector,
Enclosure	ABS Plastic
Mounting	Wall Mounting
LED Indication	Power ON, Network
Operating Temp	-10°C ~ +50°C
Dimensions (L x W XH)	120 x 80 x 43 (mm)
Antenna	SMA Rubber / WHIP Antenna*
Aux Supply (DC Voltage)	7 – 35V DC

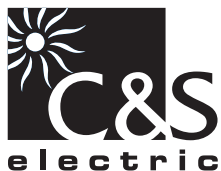

Mounting Arrangement

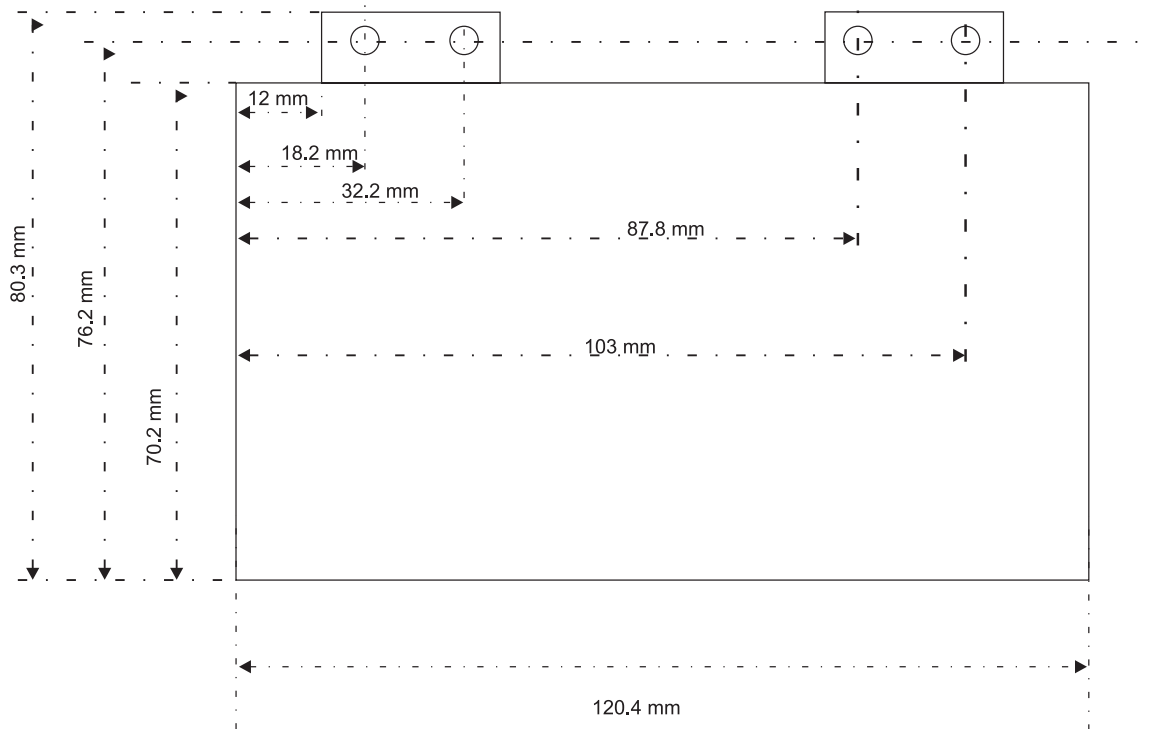

Terminal Detail

DB9 Interface: Pin 2 : Rx
 Pin 3 : Tx
 Pin 5 : GND

Supply Terminal

L+ : Positive DC Terminal
L- : Negative DC Terminal
E : Earth

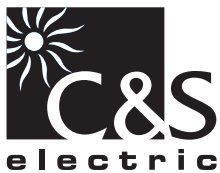

C&S Electric Limited

(Protection & Control Division)

44, Okhla Industrial Estate, New Delhi -110 020 (INDIA)

Phone : +91 11- 66602414, 30883745/54/64 Fax: +91 11- 66602413

E-mail: cspc@cselectric.co.in Web : www.cselectric.co.in

Marketing Offices :

AHMEDABAD: +91 79 30074534/35/36 FAX : +91 79 30074519 **BANGALORE:** +91 80 25586147, 25594939 FAX : +91 25584839
BHUBANESWAR : +91 674 2507265 FAX : +91 674 2507265 **CHANDIGARH :** +91 172 272613, 3062624 FAX : +91 172 2726153
CHENNAI : +91 44 39180531/32/33/34 FAX : +91 44 39180514 **DELHI :** +91 11 30838822-25 Fax: +91 11 30838826 **HYDERABAD :** +91 40 27813003
FAX : +91 40 27812987 **KOLKATA :** +91 33 22275850/51 FAX : +91 33 22275849 **MUMBAI :** +91 22 24114727/28 FAX : +91 22 24126631
NAGPUR : +91 712 5616651 FAX : +91 712 5616651 **PUNE :** +91 20 30283244/45 FAX : +91 20 30283245 **RAIPUR :** +91 771 320852433/34